

GENERAL NOTES:

1. ALL CONSTRUCTION SHALL CONFORM TO 2000 INTERNATIONAL RESIDENTIAL CODE (IRC) OR THE 2006 IRC, N.C.S.A. & OTHER MUNICIPALITIES THAT HAVE ADOPTED THE 2006 IRC.
2. BUILDER SHALL VERIFY ALL LOT DIMENSIONS, EXISTING BUILDING LINES, ADJACENT EXISTING HEIGHT RESTRICTIONS, ROOF OVERHANGS & GUTTER LIMITATIONS, FINISH AND ALL RELEVANT RESTRICTIONS PRIOR TO COMMENCING CONSTRUCTION.
3. BUILDER & ALL SUBCONTRACTORS SHALL VERIFY ALL DIMENSIONS & NOTIFY ARCHITECT OF ANY DISCREPANCIES IMMEDIATELY BEFORE COMMENCING ANY WORK.
4. ALL DIMENSIONS SHALL BE TO FACE UNLESS OTHERWISE SPECIFIED. DIMENSIONS BY G.P.P. DO NOT CONVEY WITH THIS SET. ROOMS SHALL HAVE A MINIMUM OF 8'1" TIGHT CLEARANCE OPENING WIDTH OF 20" FINISHED FLOOR HEIGHT OF 2" AND A MINIMUM ABOVE THE FLOOR & PER REC SEC 702.
5. ABOVE THE FLOOR & PER REC SEC 702.
6. ONE-WAY RATED GYPSUM BOARD SHALL BE INSTALLED UNDER STAIRS.
7. ALL ELECTRICAL WORK SHALL BE INSTALLED IN ACCORDANCE WITH REC SECTION 220.0 & 220.1.
8. ELECTRICAL CONTRACTOR TO LOCATE 200V OUTLET.
9. COMPRESSOR (G.P.P. IF NOT IN EXIST.)
10. FACTORY BUILT TRIMPLACES SHALL BE INSTALLED IN ACCORDANCE WITH REC SECTION 10.0.
11. ROOMS SHALL BE TYPED IN ACCORDANCE WITH REC SECTION 10.0.
12. HANDRAILS SHALL BE INSTALLED ALONG ALL STAIRS WITH 4" OR MORE RISER PER REC SEC. R101.
13. AND CONFORM TO ALL CITY & COUNTY ORDINANCES & CODES.
14. WALLS SHALL BE BRACED IN ACCORDANCE WITH REC SEC. R602.0.
15. ALL WORK SHALL BE IN ACCORDANCE WITH ALL CITY & COUNTY ORDINANCES & CODES.
16. N.A.S.A. UNDER REC 2006, PROJECTIONS LESS THAN 5" FROM FINISH LINE SHALL HAVE A CHAMFER WITH A MINIMUM RADIUS OF 1/8" ON THE UNDERSIDE & SHALL NOT BE MORE THAN 1/8" FROM FINISH LINE.
17. N.C.S.A. & OTHER MUNICIPALITIES THAT HAVE ADOPTED THE 2006 IRC.

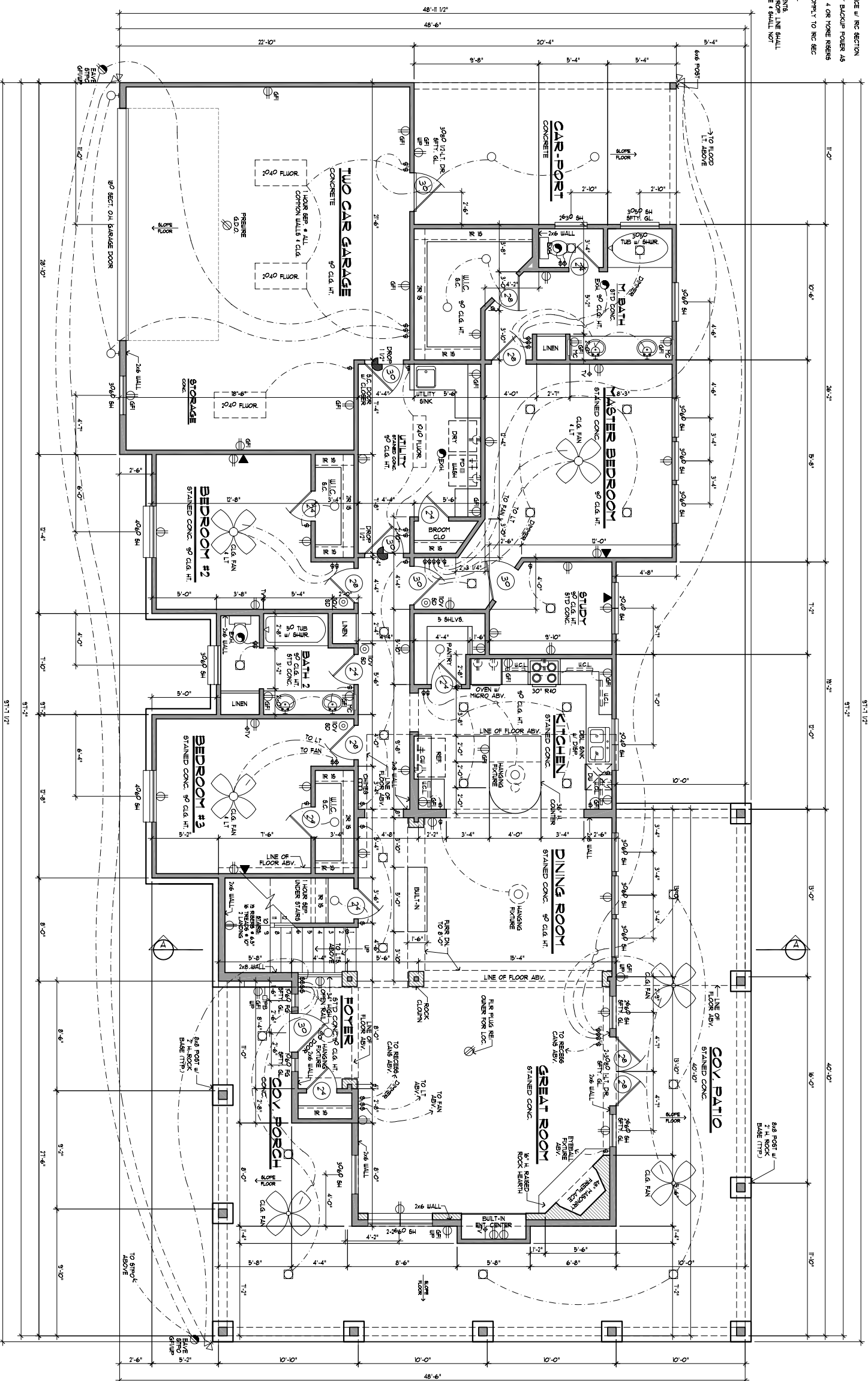

FIRST FLOOR PLAN

SCALE: 1/8" = 1'-0"
 5'-0" FLOOR HEIGHT (ASST. FIN.)
 6'-6" DOOR HEIGHT (FIN.)
 NOTE: SEE DRAWINGS FOR FINISH PLAN

DK	4-4-08	PRELIM SKETCH
AA	5-2-08	REVISED PRELIM
AA	6-5-08	REVISED PRELIM
AA	7-5-08	CD'S
AA	8-8-08	CHANGES

These drawings are incomplete and may not be used for regulatory approval, permit or construction, for review only. Brent R. Anderson, AIA, Registered Architect, State of Texas, 17241.

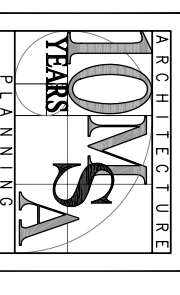

MSA ARCHITECTURE & PLANNING
 CELEBRATING 10 YEARS
 IN BUSINESS

16719 HUEBNER ROAD
 BLDG. 3 SUITE 301
 SAN ANTONIO, TX
 TEXAS 78248
 210 408 7553 VOICE
 210 408 7543 FAX
 WWW.MSAOFFSA.COM

THIS PLAN AND THE DESIGN CONTAINED HEREIN ARE THE PROPERTY OF MSA ARCHITECTURE AND PLANNING. ALL RIGHTS ARE RESERVED AND NOT TO BE REPRODUCED, COPIED, OR TRANSMITTED IN ANY FORM OR BY ANY MEANS, ELECTRONIC OR MECHANICAL, INCLUDING PHOTOCOPYING, RECORDING, OR BY ANY INFORMATION STORAGE AND RETRIEVAL SYSTEM, WITHOUT THE WRITTEN PERMISSION OF MSA ARCHITECTURE AND PLANNING. THE DESIGNER SHALL BE RESPONSIBLE FOR THE STRUCTURE, UNDERLAYING AND FOUNDATION DESIGN FOR THIS PROJECT. MSA OF SAN ANTONIO, INC. IS NOT TO BE HELD RESPONSIBLE FOR THE FINANCIAL DESIGN AND CONSTRUCTION OF THIS PROJECT.

DANCO BUILDERS

A CUSTOM HOME FOR:
MALCOLM & PEGGY MATTHEWS
 KERR COUNTY, TX

FIRST FLOOR PLAN

SQUARE FOOTAGE:	215	Sq.Ft.
FIRST FLOOR	215	Sq.Ft.
SECOND FLOOR	215	Sq.Ft.
TOTAL FLOORING	430	Sq.Ft.
COVERED PORCH	430	Sq.Ft.
UNFINISHED STORAGE	430	Sq.Ft.
GOV. PORCH	215	Sq.Ft.
CAR-PORT	215	Sq.Ft.
TOTAL COVERAGE	435	Sq.Ft.